



# RISESUN

## HIGH VOLTAGE INSULATORS 高壓支持礙子



## LOW VOLTAGE INSULATORS 低壓支持礙子





## HIGH VOLTAGE INSULATORS 高壓支持礙子規格表

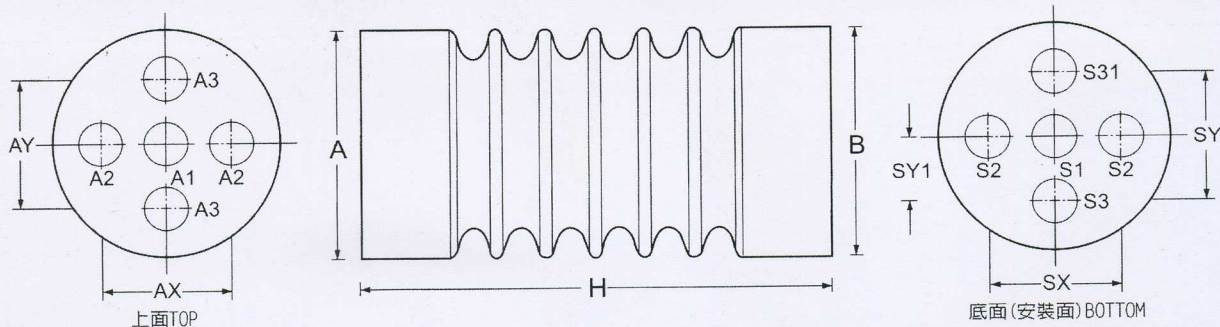

- 1.材料：BMC/EPOXY電氣絕緣材料。
- 2.螺母：黃銅，其規格、數量和位置等可依設計而定。
- 3.測試規範：JIS C3801和JIS C3851。
- 4.顏色：咖啡色或暗紅色。
- 5.尺寸和特性：請參考下表。

1. Material: Bulk molding compound, unsaturated polyester resin based or EPOXY based.
2. Nut inserts: Brass, various specifications are available.  
Arrangement of nut inserts can be designed upon request.
3. Test specifications: JIS C3801 and JIS C3851.
4. Color: Dark brown or dark red.
5. Dimension and characteristics: (Shown below)

件號 Part. No.	RS-30N	RS-20N	RS-10N	RS-10H	RS-25	RS-24	RS-15	RS-12	RS-6M	RS-3M	RS-6S	RS-3S
兩端外徑, $\phi$ (A/B), mm	End diameters (A/B), mm	100	85/90	75/80	75/80	70	70	70	58	70	55	50
高度(H), mm	Height (H), mm	310	210	145	115	230	210	142	130	90	60	50
表面漏洩距離, mm	Surface leakage distance, mm	630	330	240	190	375	356	210	172	125	88	130
定格電壓, kV	Rated voltage, kV	36	22	16.5	12	25	24	15	12	7.2	3.6	7.2
低頻耐電壓強度1分鐘, kV	Low frequency dielectric strength, kV	75	50	36	28	60	60	50	36	22	16	22
衝擊波耐電壓強度, kV	Impulse voltage resistance, kV	200	125	95	75	150	125	110	95	75	60	45
耐曲折強度1分鐘, kg	Persistent bending strength, 1min, kg	500	600	600	600	300	300	400	300	400	250	150
拉伸強度, kg	Tensile strength, kg	>3000	>2000	>2000	>2000	>2000	>1500	>2000	>1200	>1200	>1800	>1000
扭力強度, kg-m	Torque strength, kg-m	>25	>25	>25	>25	>25	>25	>25	>25	>25	>25	>20
螺母排列 INSERTS ARRANGEMENT	上面 TOP	A1	M16	M10	M10	---	---	M10	M10	M10	M10	---
		A2	M8	M8	M8	M10	---	---	M8	M8	M8	---
		A3	---	M10	M10	M10	M8	M8	---	---	---	M8
		AX	40	24	34	34	40	---	36	40	40	---
		AY	---	40	40	40	40	---	---	---	---	32
	下面 BOTTOM	S1	M16	---	---	---	M10	M10	M10	M10	M10	M8
		S2	---	M10	M10	M10	---	---	---	---	---	---
		S3	M4	M10	M10	---	M10	---	---	---	---	---
		S31	---	M10	M10	---	M10	---	---	---	---	---
		SX	---	40	40	40	---	---	---	---	---	---
		SY	---	40	40	---	40	---	---	---	---	---
		SY1	30	---	---	---	---	---	---	---	---	---

## LOW VOLTAGE INSULATOR DIMENSION 低壓支持礙子尺寸表

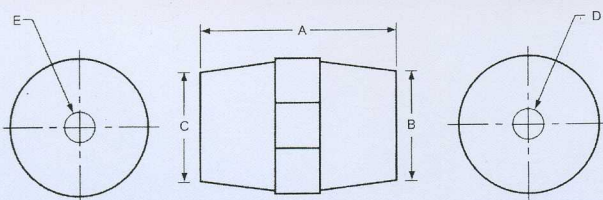

單位unit:mm

ITEM NO.	A	B	C	D	E
RM-25/RM-25S	25	30	22.9	M6	M6
RM-35S	35	42	37	M8	M8
RM-35/RM-35A	35	32	28	M8	M8
RM-40A/RM-40AB	40	40	30	M8	M8
RM-51/RM-51A	51	36	29	M8	M8
RM-76/RM-76A	76	50	36	M10	M10

## BUSBAR CLAMP DIMENSION L型銅排夾具、檔片及電纜線夾具尺寸表

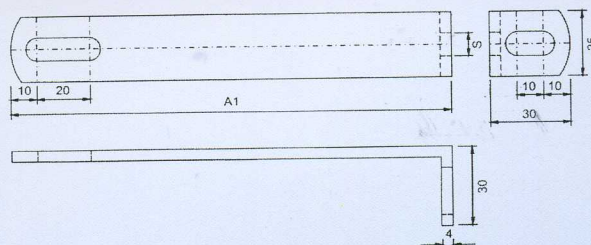

Dimension NO. 件號	S	銅排固定側 Busbar side A1	適用銅排寬 Busbar width	備註 Remark
BC-1	9	75	40-60	每組含夾板2片 及M8螺絲一組 One set contains two pieces and M8 screws.
BC-2	9	100	60-80	
BC-3	9	120	80-105	
BC-4	9	140	105-125	
BC-5	9	165	125-150	
BC-1A	10.5	75	40-60	
BC-2A	10.5	100	60-80	
BC-3A	10.5	120	80-105	
BC-4A	10.5	140	105-125	
BC-5A	10.5	165	125-150	



# BUSBAR SUPPORTS 銅排夾尺寸表

BS-60

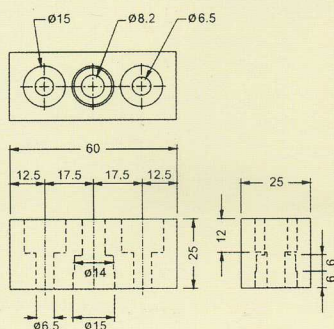

BS-105

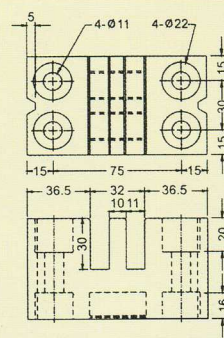

BS-130

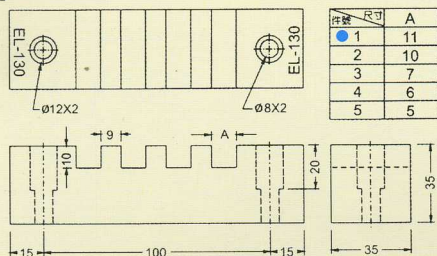

BS-155

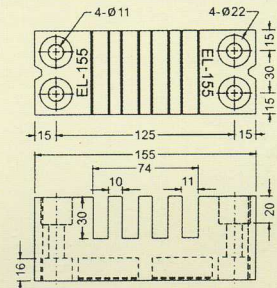

BS-170

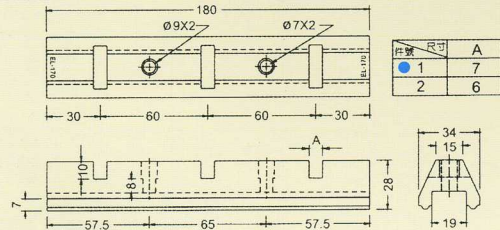

BS-270

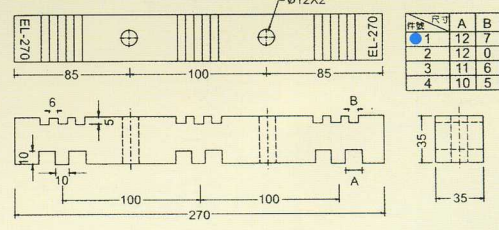

BS-180

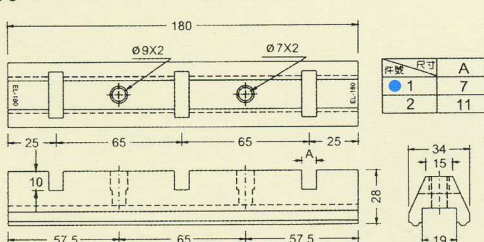

BS-295

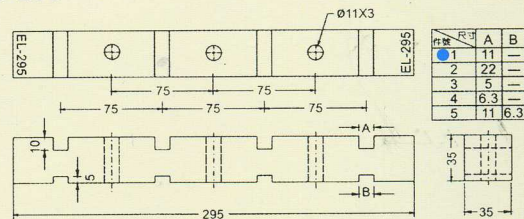

BS-210

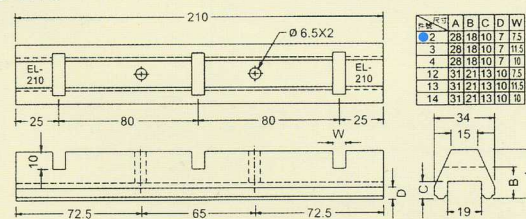

BS-409

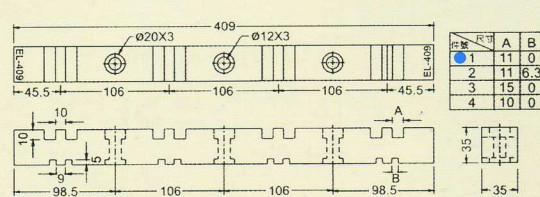



## BUSBAR SUPPORTS 銅排夾

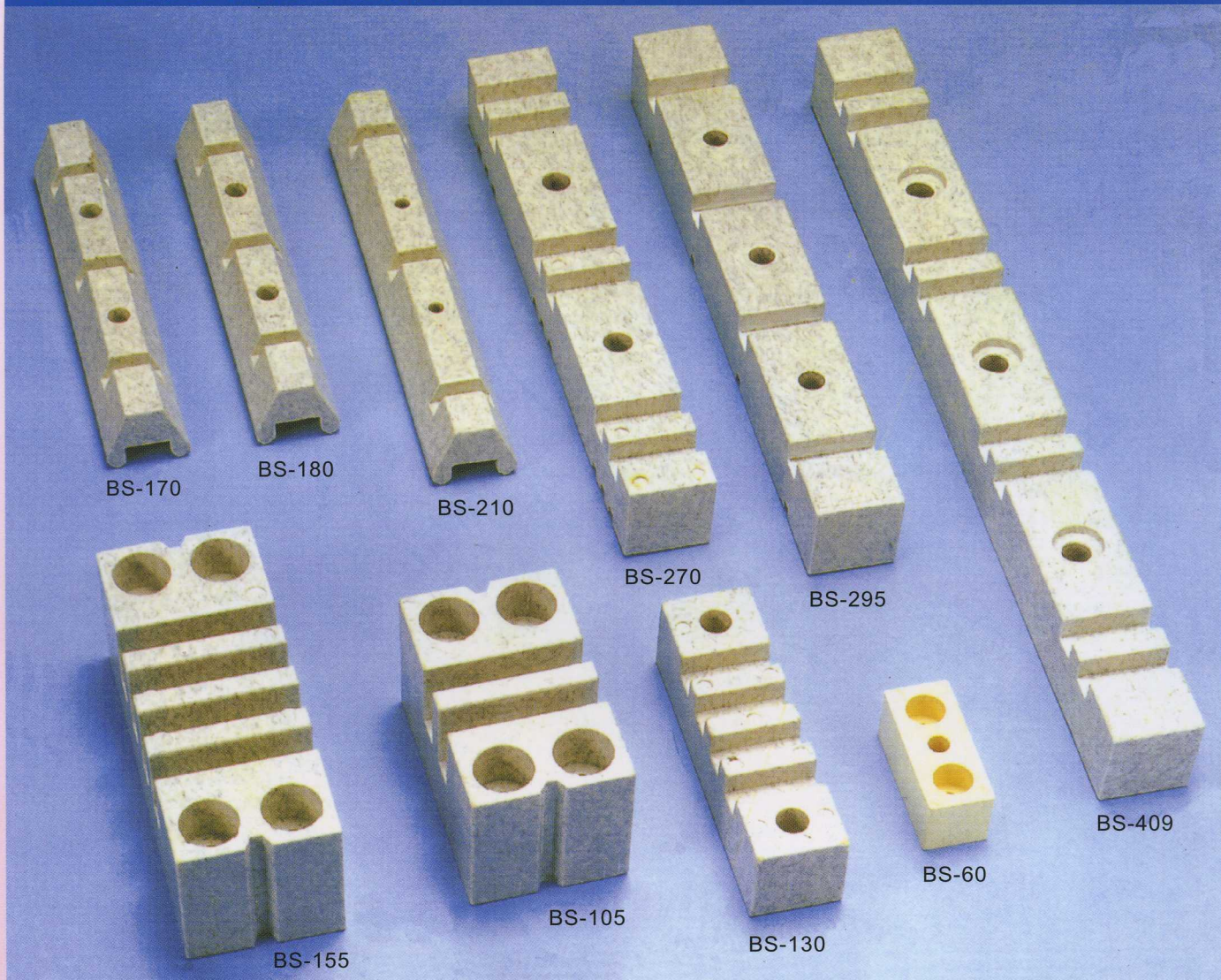

## TAP CHANGE 切換器

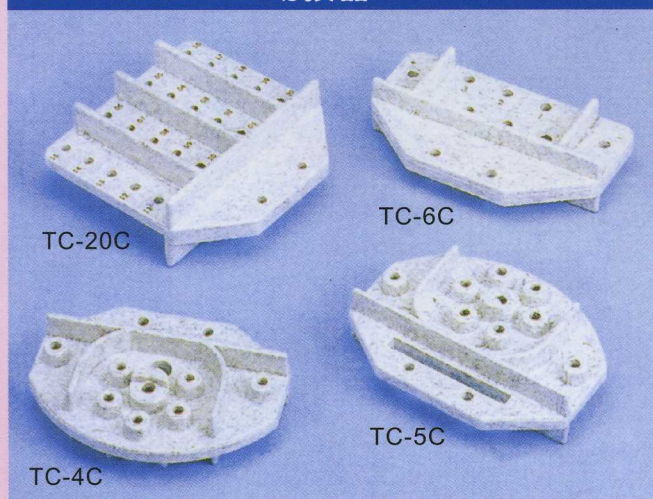

## BUSBAR CLAMP L型銅排夾具.檔片及電纜線夾

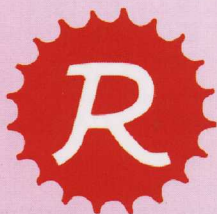

MANUFACTURERS

**RISESUN ELECTRICAL & INDUSTRIAL CO., LTD.**

OFFICE : Rm3C-07, Taipei World Trade Center, 5, Hsin Yi Road, Sec.5, Taipei, Taiwan

P.O.BOX.87-934, TAIPEI, TAIWAN,

TEL : (02)2723-3859(REP), 2723-3903, 2723-2768, 2723-2989

FAX : (02)2725-1763, 8788-3761

E-mail : risesun@ms5.hinet.net.

Internet : <http://www.risesun.com.tw/>

